

## CREATING THE NEW KALINGA PARK

Upon completion of the Airport Link Project Thiess John Holland will reinstate Kalinga Park with increased parkland, recreational upgrades and new pathway connectivity, improving the Clayfield/Toombul community's access to the Kedron Brook Pathway, parks public transport and local amenities.

### ***Kalinga Park Land Bridge***

A land bridge on the western side of Sandgate Road will improve connectivity between local residential communities, the railway station and bus interchange, and maintain the landscape integrity of the Kalinga Park corridor. The land bridge will include an extension of Diggers' Drive's historic links to a contemplation area, terraced lookouts and new pathway access from Alma and Stuckey Roads and Elliott Street.

### ***Kalinga Park Open Field***

The open field immediately west of the North Coast Railway Line will be reinstated and will feature new pathways connecting the realigned Eagle Junction Creek Bridge with Diggers' Drive and Kalinga Park East, a soft mound playground and BBQ facilities.

### ***Schulz Canal east of Sandgate Road***

More than 18,000m<sup>2</sup> of green space and pathway will be reinstated between Sandgate Road and Widdop Street. This will include use of the existing Schulz Canal Bridge that previously connected Centro Toombul and the overflow car park. In addition the traffic signals and pedestrian refuge island installed north of East West Arterial Road, on Widdop Street will remain in place as requested by the Toombul Community Liaison Group.

### ***Ross Park***

Following the successful relocation of hoop pines from the Airport Roundabout to Ross Park and opening of the new pathway connection from Schulz Canal to the western side of Sandgate Road, TJH will reinstate the BMX Track and construct a new pathway connection from the Northern Schulz Canal Pathway to Parkland Street to complete the Ross Park upgrade.

### ***Living Green Wall***

68 different species of plants, used in 44 different arrangements will create a unique driving experience for motorists travelling through Airport Link. The *Living Green Wall* will be up to 4.5m high and will span 155m along both sides of the tunnel portal at Toombul.

A sophisticated electronic irrigation system will remotely monitor and adjust settings of water usage according to the plants requirements.



# DEMOBILISING & REINSTATING KALINGA PARK

From August 2011 construction activities will focus on the installation of smoke duct slabs and closing of the tunnels' roof structures. As each section of the cut and cover tunnels is progressively closed, surface construction will take place to demobilise temporary construction infrastructure and reinstate Kalinga Park.

**Demobilisation.** As construction of Airport Link advances, TJH will demobilise its temporary infrastructure such as support equipment, flood walls, sheds, office facilities, noise barriers and the construction access road. These activities will take place progressively before permanent infrastructure, such as pathways, pathway bridges and the Lewis Street drain realignment are constructed on the demobilised construction area and reinstatement works such as the Lewis Street cul de sac commence.

**Reinstatement** activities will include removal and delivery of materials to backfill Kalinga Park on top of the tunnel and along the Construction Access Road to Widdop Street in preparation for the planting of more than 118,000 plants and trees and laying of turf.

Throughout this work site access to and from the Kalinga Park Worksite will become progressively restricted. This will mean that the use of local roads connecting into Kalinga Park will become unavoidable.

**Mitigation** will include the use of dust suppression onsite, water carts and street sweepers, covered loads, regular road inspections, planning and sequencing of activities to ensure the efficient completion of construction while minimising environmental and community impacts.

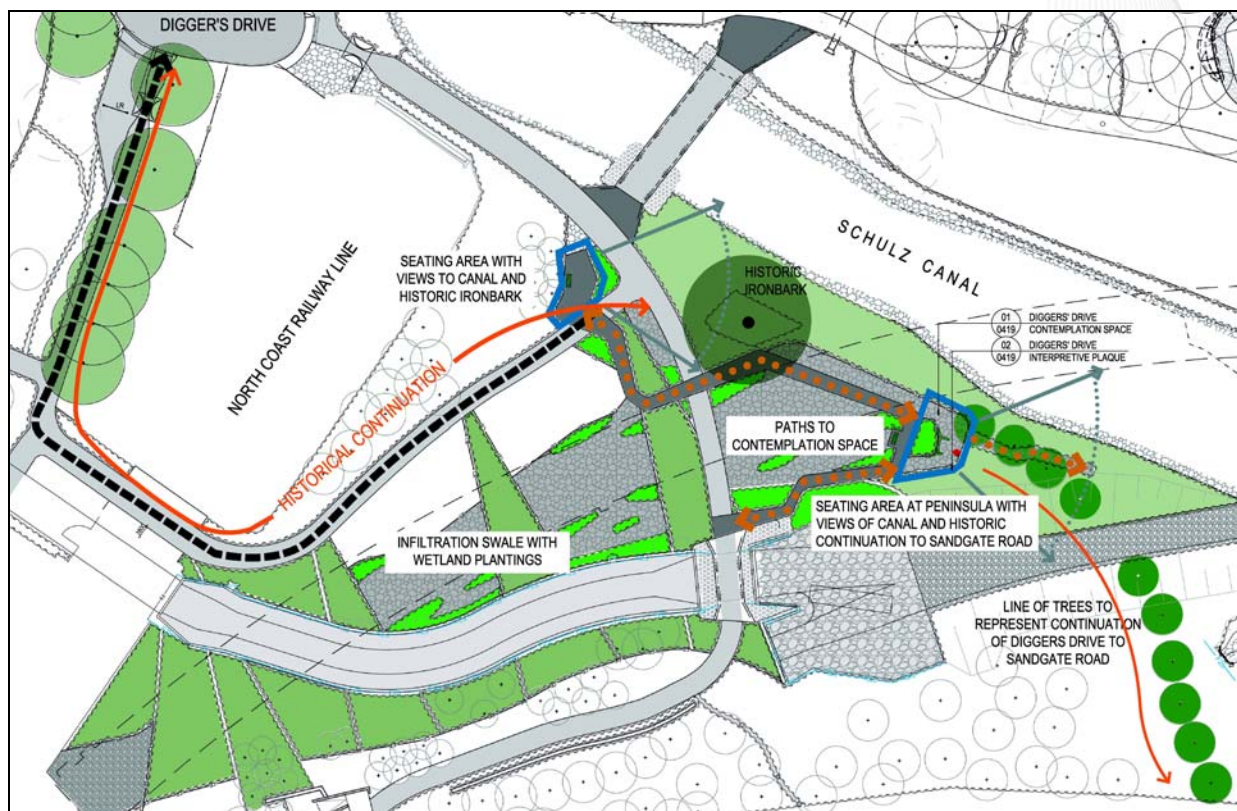

**Kalinga Park Historic Continuation and Contemplation Space**